

Locking Plungers

- ▶ Available in zinc-plated steel or stainless steel
- ▶ Includes nylon patch for positive holding
- ▶ Plunger can be completely withdrawn into the thread and locked into place

STANDARD LENGTH

Steel PART #	Stainless Steel PART #	End Pressures		A	B	C	D	E	F	G	H	I
		Start	Full									
LP-10	LP-10SS	.5	2.5	1/4-20	.156	3/8	5/8	1-5/8	1/4	5/8	3/32	1/2
LP-14	LP-14SS	.75	3.0	5/16-18	.186	1/2	7/8	2-1/8	5/16	3/4	7/64	9/16
LP-11	LP-11SS	.75	3.75	3/8-16	.250	9/16	1-1/16	2-9/16	3/8	15/16	9/64	11/16
LP-12	LP-12SS	1.0	5.0	1/2-13	.312	3/4	1-1/8	2-7/8	1/2	1-1/4	3/16	3/4
LP-13	LP-13SS	1.0	5.0	5/8-11	.375	1	1-3/4	4	5/8	1-5/16	3/16	1-1/16

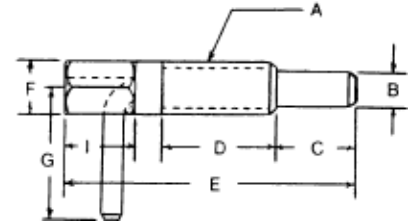

SHORT LENGTH

Steel PART #	Stainless Steel PART #	End Pressures		A	B	C	D	E	F	G	H	I
		Start	Full									
LP-20	LP-20SS	.125	.50	1/4-20	.156	3/16	7/16	15/16	1/4	17/32	3/32	1/4
LP-24	LP-24SS	.25	1.0	5/16-18	.186	1/4	1/2	7/8	5/16	5/8	7/64	5/16
LP-21	LP-21SS	.25	1.25	3/8-16	.250	5/16	5/8	1-7/16	3/8	3/4	9/64	3/8
LP-22	LP-22SS	.50	2.0	1/2-13	.312	13/32	7/8	1-29/32	1/2	1	3/16	1/2
LP-23	LP-23SS	.75	2.5	5/8-11	.375	1/2	1-1/8	2-3/8	5/8	1-3/16	3/16	5/8

Locking Plungers Delrin® nose

- ▶ Available in zinc plated steel and stainless steel
- ▶ Delrin® nose prevents marring of aluminum, brass or other soft materials
- ▶ Plunger can be completely retracted into the thread and locked into place
- ▶ Includes nylon patch for positive holding

STANDARD LENGTH

Steel PART #	Stainless Steel PART #	End Pressures		A	B	C	D	E	F	G	J
		Start	Full								
LP-50	LP-50SS	0.5	2.5	1/4-20	.156	3/8	5/8	1-1/4	1/4	5/8	1/2
LP-54	LP-54SS	0.75	3.0	5/16-18	.186	1/2	7/8	1-5/8	5/16	3/4	9/16
LP-51	LP-51SS	0.75	3.75	3/8-16	.250	9/16	1-1/16	2"	3/8	15/16	11/16
LP-52	LP-52SS	1.0	5.0	1/2-13	.312	3/4	1-1/8	2-1/8	1/2	1-1/4	3/4
LP-53	LP-53SS	1.0	5.0	5/8-11	.375	1"	1-3/4	3"	5/8	1-5/16	1-1/16

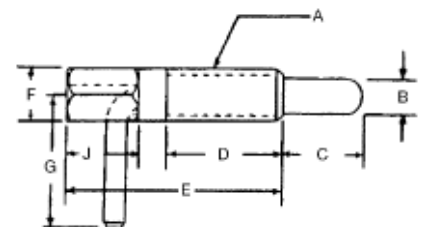

SHORT LENGTH

Steel PART #	Stainless Steel PART #	End Pressures		A	B	C	D	E	F	G	J
		Start	Full								
LP-60	LP-60SS	.125	0.5	1/4-20	.156	3/16	7/16	3/4	1/4	9/16	1/4
LP-64	LP-64SS	.25	1.0	5/16-18	.250	1/4	1/2	7/8	5/16	5/8	5/16
LP-61	LP-61SS	.25	1.25	3/8-16	.250	5/16	5/8	1-1/8	3/8	3/4	3/8
LP-62	LP-62SS	.5	2.0	1/2-13	.312	13/32	7/8	1-1/2	1/2	1"	1/2
LP-63	LP-63SS	.75	2.5	5/8-11	.375	1/2	1-1/8	1-7/8	5/8	1-3/16	5/8